

12
mm

Metal
五金



ZWMD012012

齿轮箱规格 Gearbox specifications

| | | | | |
|----------------------------|----------|----------------------------------------|---------------------|----------------------|
| 外径 Outer diameter | 12mm | 轴承 Bearing | 烧结轴承 Porous Bearing | 滚动轴承 Rolling bearing |
| 材质 Material | 五金 Metal | 轴向窜动 Axial endplay | ≤0.3mm | ≤0.2mm |
| 旋转方向 Direction of rotation | cc & ccw | 输出轴径向负载 Radial loading on output shaft | ≤10N | ≤20N |
| 齿轮箱回程差 Gear backlash | ≤3° | 工作温度 Operating temperature range | -20 ~ +85°C | |

齿轮级数 Gearbox stages

| | 1 | 2 | 3 | 4 |
|-------------------------------------------------|-------|--------------|---------------------|------------------------------|
| 减速比 Reduction ratio | 4 / 6 | 16 / 24 / 36 | 64 / 96 / 144 / 216 | 256 / 384 / 576 / 864 / 1296 |
| 最大容许扭力 (gf.cm max) Max rated torque of gear box | 2000 | 2000 | 2000 | 2000 |
| 瞬间容许力矩 (gf.cm max) Instant torque of gear box | 6000 | 6000 | 6000 | 6000 |
| 齿轮箱效率 Gearbox efficiency | 87 | 74 | 63 | 56 |
| 长度 Length | 12.4 | 16.2 | 20 | 23.8 |

技术插图 | Technical illustrations

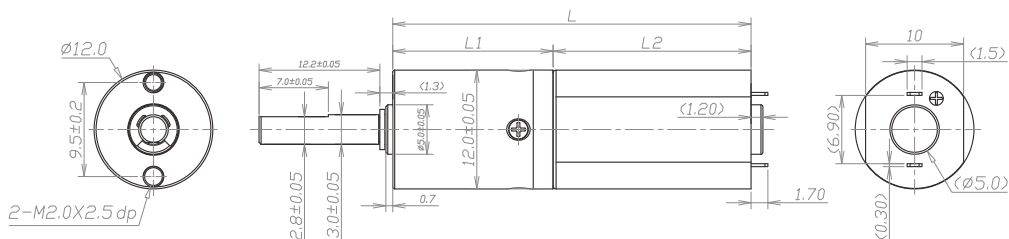

马达规格参数 Motor specifications

| | | | |
|---------------------------|-------------------------------------------------------------------------|------------------|-----------|
| 马达(可选择) Motors(Optional) | 直流有刷电机、直流无刷电机、步进电机 DC brush motor, DC brushless motor, Stepper motor | 输入速度 Input speed | ≤30000rpm |
| 电压(可选择) Voltage(Optional) | 3-24V | 电流 Current | 250MA max |

| 型号 Model | Rated Speed 额定转速 | Max Speed 最高转速 | Max Rated Torque 额定容许力矩 | Max Instant Torque 瞬间容许力矩 | Reduction ratio 减速比 | Length 减速箱长 L1 | Overall Length 总长 L |
|-----------------|---------------------|-------------------|----------------------------|------------------------------|------------------------|-------------------|------------------------|
| | rpm | rpm | gf.cm | gf.cm | | mm | mm |
| ZWMD012012-4 | 1875 | 7500 | 2000 | 6000 | 4 | 12.4 | 32.4 |
| ZWMD012012-6 | 1250 | 5000 | 2000 | 6000 | 6 | | |
| ZWMD012012-16 | 469 | 1875 | 2000 | 6000 | 16 | 16.2 | 36.2 |
| ZWMD012012-24 | 313 | 1250 | 2000 | 6000 | 24 | | |
| ZWMD012012-36 | 208 | 833 | 2000 | 6000 | 36 | | |
| ZWMD012012-64 | 117 | 469 | 2000 | 6000 | 64 | | |
| ZWMD012012-96 | 78 | 313 | 2000 | 6000 | 96 | 20 | 40 |
| ZWMD012012-144 | 52 | 208 | 2000 | 6000 | 144 | | |
| ZWMD012012-216 | 35 | 139 | 2000 | 6000 | 216 | | |
| ZWMD012012-256 | 29 | 117 | 2000 | 6000 | 256 | | |
| ZWMD012012-384 | 20 | 78 | 2000 | 6000 | 384 | 23.8 | 43.8 |
| ZWMD012012-576 | 13 | 52 | 2000 | 6000 | 576 | | |
| ZWMD012012-864 | 9 | 35 | 2000 | 6000 | 864 | | |
| ZWMD012012-1296 | 6 | 23 | 2000 | 6000 | 1296 | | |

注：可根据客户要求定制 Can customize product as requirements